

# ARB AIR LOCKER *Air Operated Locking Differentials*

## RD30

Dana 30,27 SPL,3.73 & UP\*\*

## Specs:

Axle Spline	27 tooth, Ø29.5mm [1.16"]
Ratio Supported	3.73:1 & up
Ring Gear ID	114.3mm [4.50"]
Ring Gear OD	183mm [7.2"]
Ring Gear Bolts	10 bolts on Ø133mm [5.24"]
Ring Gear Torque	75Nm [55 ft-lb]
Backlash	0.15-0.25mm [0.006-0.010"]
Bearing Cap Torque	81Nm [60 ft-lb]

## Notes:

- 1 For replacement O-rings use only BS028 Viton 75.
- 2 For replacement bearing use Timken part # LM501349 / LM501310.

Not for use in IFS Dana 30 models.

ITEM #	QTY	DESCRIPTION	PART #	NOTES
01	1	FLANGE CAP	021801	
02	1	CLUTCH GEAR	050501	
03	1	DIFFERENTIAL CASE	011901	
04	4	RETURN SPRING	150102	
05	4	CROSS SHAFT RETAINING PIN	120401	
06	1	LONG CROSS SHAFT	060104	
07	2	SHORT CROSS SHAFT	060306	
08	1	PISTON	040601	
09	1	U-RING	160303	
10	1	CYLINDER CAP	030901	
11	2	SEAL HOUSING O-RING	160210	1
12	6	CYLINDER CAP RETAINING BOLT	200207	
13	6	LOCKING TAB (6mm)	150402	
14	1	TAPERED ROLLER BEARING	160105	2
15	1	SEAL HOUSING	080603	
16	1	SHIM KIT	SHK003	
17	1	SPLINED SIDE GEAR	131004R	
18	4	PINION THRUST WASHER	151105	
19	4	PINION GEAR	140501R	
20	1	SPIDER BLOCK	070501	
21	1	SIDE GEAR	130901R	
22	2	SIDE GEAR THRUST WASHER	151005	
*	1	BULKHEAD FITTING KIT	170102	
*	1	PUSH-IN FITTING (5mm to 1/8"BSPP)	170201	
*	1	AIR LINE (5mm DIA X 6m LONG)	170301	
*	1	NIPPLE (1/8" to 1/8" BSPT)	170501	
*	1	SOLENOID VALVE (12V)	180103	
*	1	SWITCH	180209	
*	1	SWITCH COVER (FRONT)	180210	
*	10	CABLE TIE	180301	
*	1	WARNING LABEL	210101	
*	1	BUMPER STICKER	210102	
*	1	OPERATION & SERVICE MANUAL	210200	
*	1	INSTALLATION GUIDE	210230	

\* Not illustrated in exploded view.

\*\* This model was superseded by **RD100** and is no longer in production.

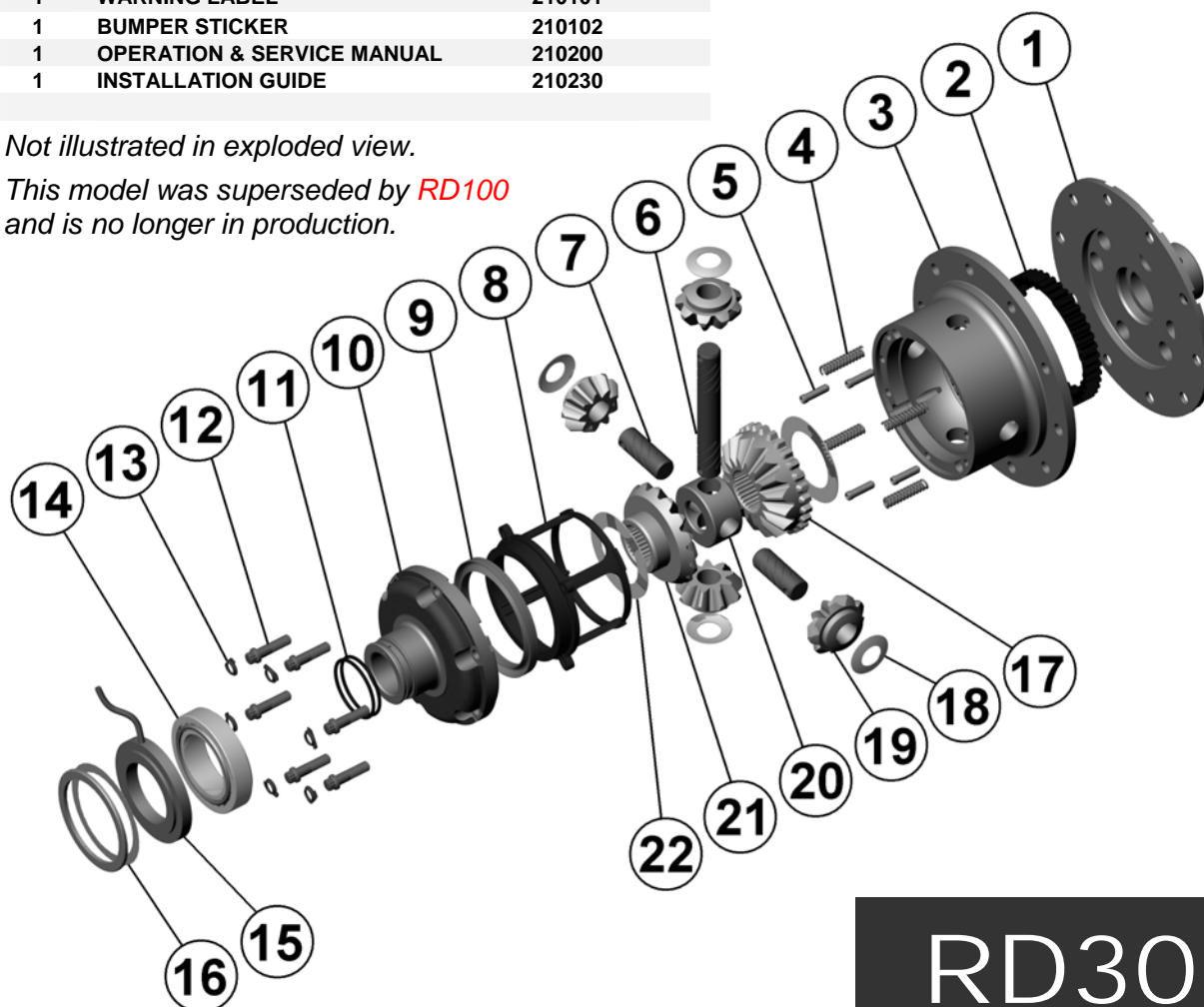

# RD30

