

# 2.0-2.5 POWER RACK SYSTEM with INTEGRATED CONTROL VALVE

## Hose installation diagram

POWER STEERING FLUID: Howe Power Steering Fluid PN 1105  
(GM Mr. Goodwrench® PN: 89020661 may be substituted if needed)

### CAUTION:

**DO NOT USE ATF (AUTOMATIC TRANSMISSION FLUID)**

Use only Sta-Lube Marine grease p/n SI3120 (tube), SI3121 (tub), any other will void warranty

NOTE: Hose lengths will vary with each installation, custom hoses must be fabricated.  
Hose Kit P/N 950 available separately.

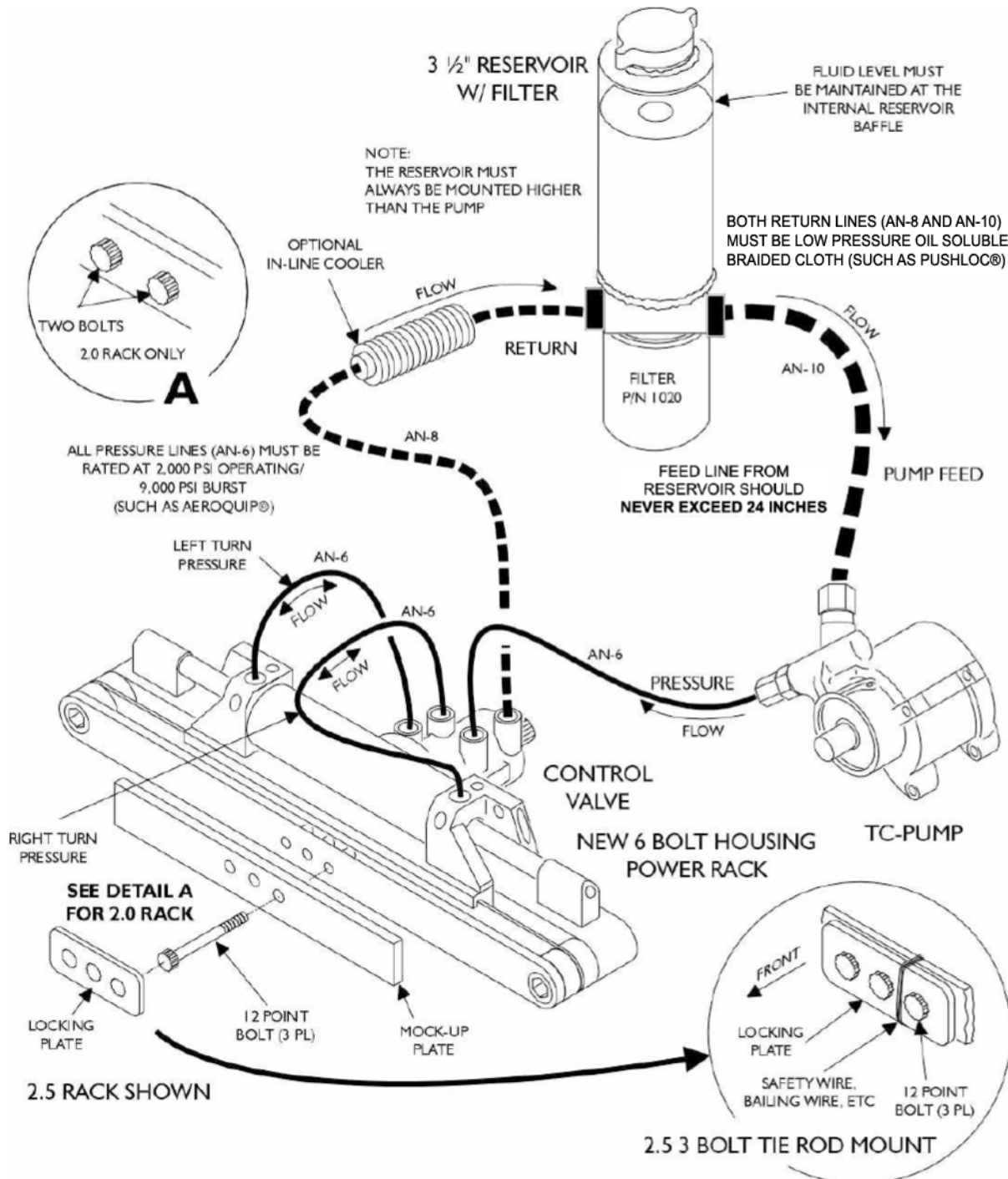

IF YOU HAVE ANY QUESTIONS ABOUT THE INSTALL CALL HOWE PERFORMANCE (619) 561-7764