

## REMOVAL

1. Remove the console upper cover plate.

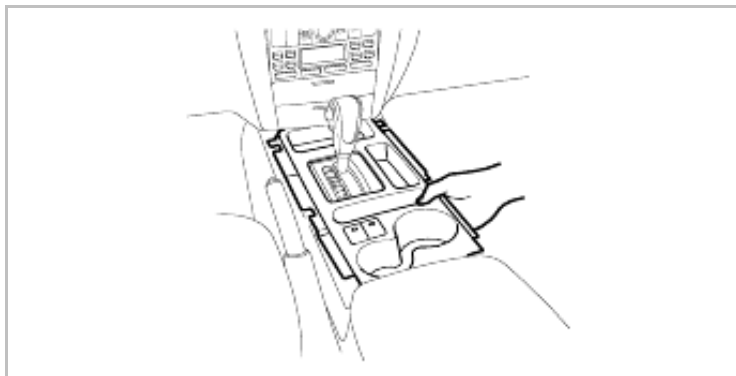

2. Remove the center console assembly.
3. Remove the control cable, the shift lock cable and key lock cable.

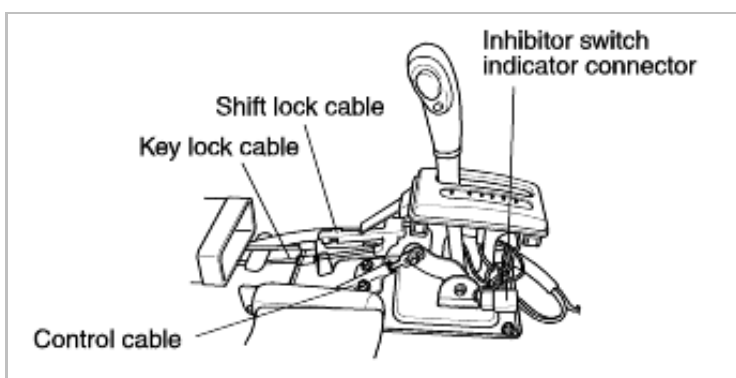

4. Disconnect the inhibitor switch indicator connector.
5. Remove the control lever assembly.

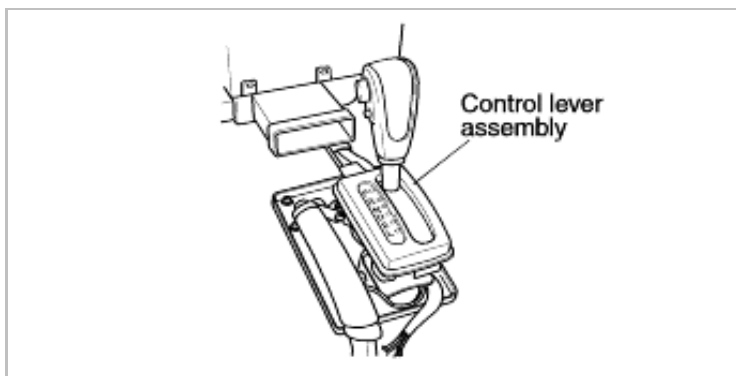

6. Remove the control lever bracket.

## SHIFT LOCK DEVICE INSTALLATION INSTRUCTIONS

### INSPECTION

- Check the detent place for wear.
- Check the bushing for wear or damage.
- Check the spring for damage or deterioration.
- Check the pin at the end of the rod assembly for wear.

### NOTE

When servicing the shift lock device, follow the service instructions and procedures described below in order to operate it normally.

1. Procedure to install the lock cam.

A. Make sure to move shift lever to position "P" to set key lock cam and p-lock as figure.

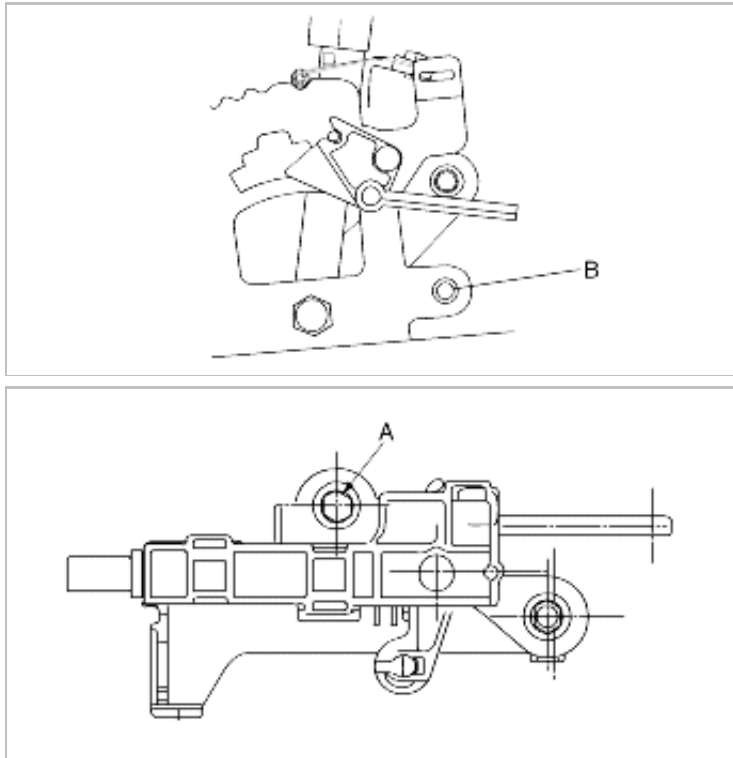

2. Procedure for adjusting "P" shift lock and key lock cable.

(1) Check that lock cam is located in position.

(2) Install shift lock cable in position as figure.

(3) Temporarily install shift lock cable to A/T lever assembly as shown in figure. Securely insert cable end into fixing pin of cam.

(4) After checking that a portion of cable end touches cable fixing pin of P-lock cam, fix shift lock cable to A/T lever.

3. Checking that procedure for installing the shift lock is correct.

(1) When the brake pedal is not depressed, push button of the shift lever at "P" position cannot be operated.  
(Shift lever cannot be shifted at the other positions from "P").  
Push button can be operated at the other positions except "P".

(2) When brake pedal stroke is 30 mm (with shift lever at "P" position), push button should be operated without catching and shift lever can be shifted smoothly to other from "P".

(3) When brake pedal is not depressed, shift lever should be shifted smoothly to "P" position from other positions.

(4) Brake pedal must be operated smoothly without catching at all positions.

(5) If shift lever is shifted to "P" position, ignition key must be turned to "LOCK" position smoothly.

(6) Adjust nut "A" and bolt "B" if necessary.